

LASER[®]

Part No. 5212

Instructions

Engine Timing Tool Kit

Ford, Land Rover, Jaguar, Volvo

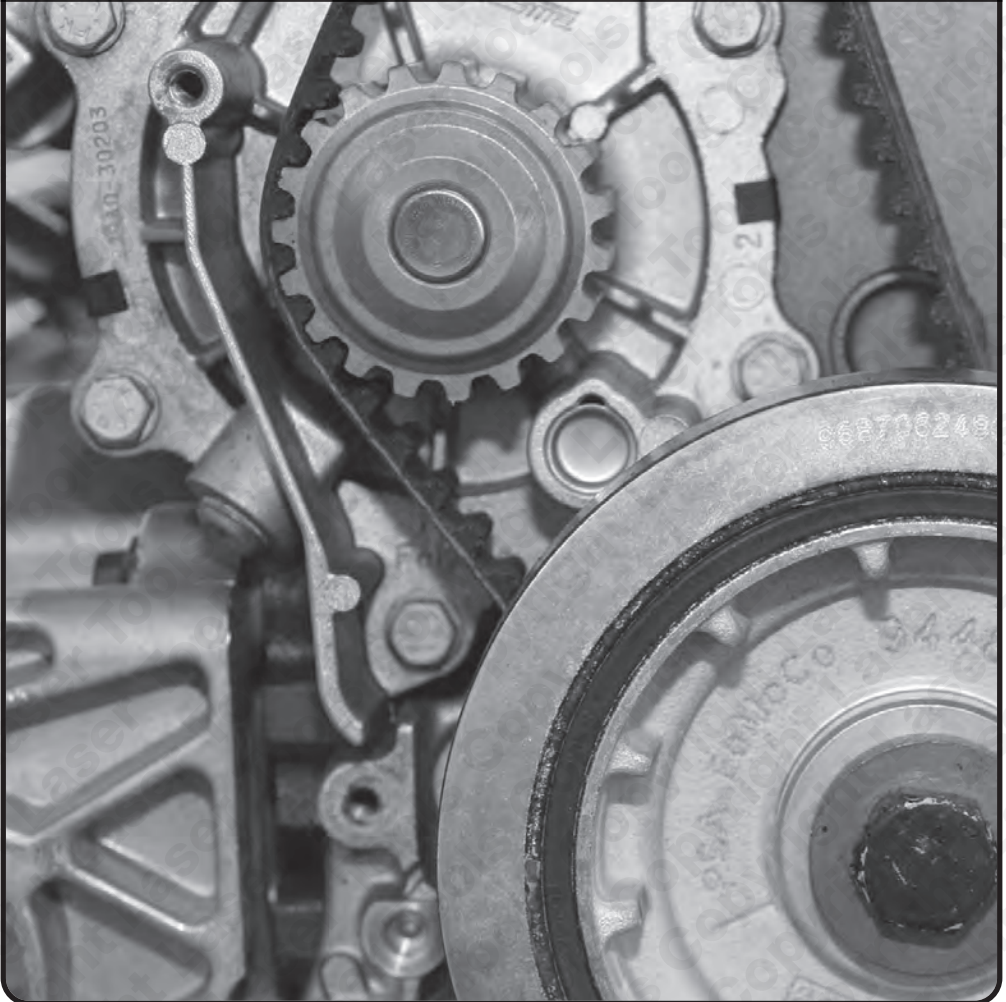

www.lasertools.co.uk

Components

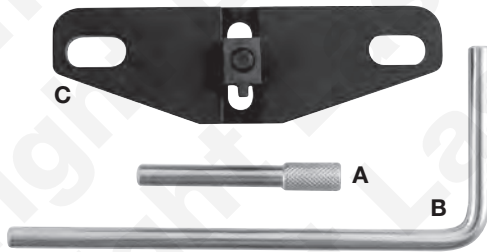

Ref.	Comp. Code	Land Rover/Ford OEM Ref.	Volvo OEM Ref.	Description
A	C101	303-1277	999-7122	Camshaft Pulley Timing Pin
B	C351	303-1270 303-1059	999-7121	Flywheel Locking Timing Pin
C	C056	303-1272	999-7119 999-7120	Flywheel/Ring Gear Locking Tool Adaptor

Applications

Manufacturer	Model	Range	Year	Engine Codes				
Ford	Focus C-MAX		2003 - 2011	2.0				
	C-MAX		2010 - 2020	AZBA	T7CA	T8CH	TXBB	UKBB
	Focus MKII, MKIII		2004 - 2015	AZBC	T7CE	T8CI	TXDA	UKDA
	Focus		2015 - 2018	AZWA	T7CF	T8CJ	TXDB	UKDB
	Grand C-MAX		2010 - 2020	AZWC	T7CJ	T8CL	TXMA	UKMA
	Galaxy		2006 - 2018	G6DA	T7CK	T8CM	TXWA	UKWA
	Kuga		2008 - 2018	G6DB	T7CL	T8CN	TYBA	XRMA
	Mondeo MkIV, MkV		2007 - 2018	G6DC	T7CN	T8CP	TYDA	XRMB
	S-MAX		2006 - 2018	G6DD	T7CP	T8DA	TYMA	XRMC
				G6DE	T7CQ	T8DE	TYWA	2.2
				G6DF	T7DA	T8DF	UFBA	KNBA
				G6DG	T7DB	T8MA	UFBB	KNBB
				IXDA	T7DD	T8MB	UFCA	KNWA
				KLBA	T7MA	T8MC	UFGB	KNWB
			KLWA	T7MB	T9CA	UFCD	Q4BA	
			LPBA	T7MC	T9CB	UFDA	Q4WA	
			QXBA	T7MD	T9CC	UFDB		
			QXBB	T7MB	T8CA	UFMA		
			QXWA	T8CC	T9CE	UFWA		
			QXWB	T8CD	TXBA	UKBA		
Jaguar	XF	(X250)	2011 - 2015	2.2				
				AJi4D/224DT				
Land Rover	Discovery Sport	(L550)	2015 - 2016	2.2				
	Freelander 2	(L359)	2006 - 2015	DW12BTED4/224DT				
	Range Rover Evoque	(L538)	2011 - 2015	DW12CTED4/224DT				
Volvo	C30		2006 - 2010	2.0				
	C70		2006 - 2010	D 4204 T				
	S40		2003 - 2010	D 4204 T2				
	S80		2007 - 2010					
	V50		2004 - 2010					
	V70		2007 - 2010					

Always refer to the website for most up to date applications: www.lasertools.co.uk/product/5212

Instructions

Developed for the 2.0/2.2 DOHC common rail diesel engines found in Ford, Land Rover, Jaguar and Volvo vehicles.

This kit allows the replacement of the timing belt whilst maintaining the correct timed position of the camshafts and crankshaft.

These engines use a Cambelt to transmit the drive from the crankshaft to one of the camshafts. The drive is then transferred from one camshaft to the other by a chain located in the cylinder head. This kit is designed for the servicing/replacement of the cambelt drive only.

The following instructions are for guidance only. Please refer to OEM derived data such as the vehicle manufacturers' own data or Autodata.

The use of this engine timing tool kit is purely down to the user's discretion and The Tool Connection Ltd. cannot be held responsible for any damage caused whatsoever.



Preparation

Remove the following components where access requires:

1. Right hand engine mount
2. Auxiliary drive belts
3. Starter motor

Component A Camshaft Pulley Timing Pin

Component A is designed to slide through the timing hole in the camshaft pulley and lock into a corresponding hole in the cylinder head.

N.B. This pin is not designed to lock the camshaft against the torque or undoing the camshaft fixing. Use an appropriate pulley holding tool if removal of the pulley is required.

Component B Flywheel Locking Pin

In order to fit the flywheel locking pin the starter motor must first be removed.

N.B. This pin is not designed to lock the crankshaft against the torque of undoing the crankshaft fixing. Use component C to lock the flywheel for this purpose.

Component C Flywheel/Ring Gear Locking Tool

Component C is used to lock the flywheel against the torque required to loosen the crankshaft pulley fixings. Component C requires the removal of the starter motor.

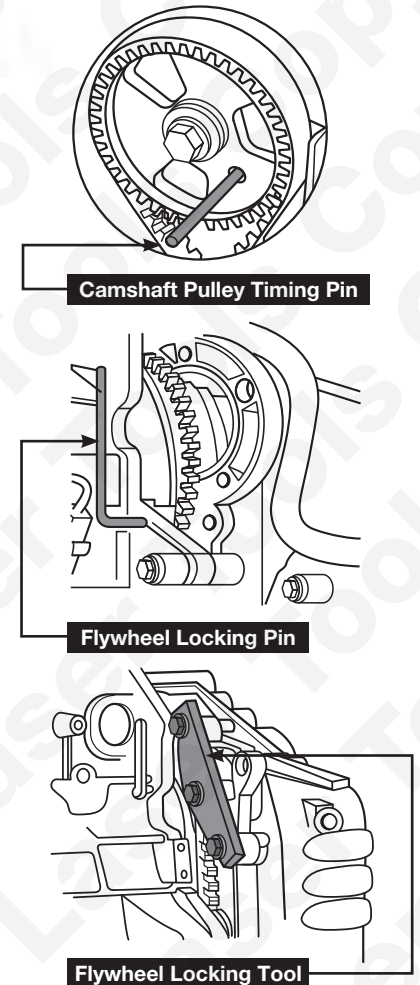

Safety Precautions – Please read

- If the engine has been identified as an Interference engine, damage to the engine will occur if the timing belt has been damaged. A compression check of all the cylinders should be taken before the cylinder head (s) are removed.
- Do not turn crankshaft or camshaft when the timing belt has been removed.
- To make turning the engine easier, remove the spark plugs.
- Observe all tightening torques.
- Do not turn the engine using the camshaft or any other sprocket.
- Disconnect the battery earth lead (Check Radio code is available).
- Do not use cleaning fluids on belts, sprockets or rollers.
- Some toothed timing belts are not interchangeable. Check the replacement belt has the correct tooth profile.
- Always mark the belt with the direction of running before removal.
- Do not lever or force the belt onto its sprockets.
- Check the ignition timing after the belt has been replaced.
- Do not use timing pins to lock the engine when slackening or tightening the crankshaft pulley bolts.
- ALWAYS REFER TO A REPUTABLE MANUFACTURERS WORKSHOP MANUAL.

Warning – incorrect or out of phase engine timing can result in damage to the valves. It is always recommended to turn the engine slowly, by hand, and to re-check the camshaft and crankshaft timing positions.

Our products are designed to be used correctly and with care for the purpose for which they are intended. No liability is accepted by the Tool Connection for incorrect use of any of our products, and the Tool Connection cannot be held responsible for any damage to personnel, property or equipment when using the tools. Incorrect use will also invalidate the warranty.

If applicable, the applications database and any instructional information provided has been designed to offer general guidance for a particular tool's use and while all attention is given to the accuracy of the data no project should be attempted without referring first to the manufacturer's technical documentation (workshop or instruction manual) or the use of a recognised authority such as Autodata.

It is our policy to continually improve our products and thus we reserve the right to alter specifications and components without prior notice. It is the responsibility of the user to ensure the suitability of the tools and information prior to their use.



5212_Instructions_V5



www.lasertools.co.uk

Guarantee



Distributed by The Tool Connection Ltd
Kineton Road, Southam, Warwickshire CV47 0DR
T +44 (0) 1926 815000 F +44 (0) 1926 815888
info@toolconnection.co.uk www.toolconnection.co.uk

If this product fails through faulty materials or workmanship, contact our service department direct on: +44 (0) 1926 818186. Normal wear and tear are excluded as are consumable items and abuse.

www.lasertools.co.uk